

Smart LED Portable Projector with Harman Kardon® Speakers

ViewSonic® See the difference™ 

M1+_G2



- Smart Wi-Fi & Bluetooth connectivity
- 360° Smart stand that allows for ceiling projection
- Integrated stereo Harman Kardon speakers
- Cinema SuperColor+™ Technology with 125% Rec.709
- Advanced LED light source with a 30,000-hour lifespan
- Up to 6 hours of battery life

The ViewSonic M1+_G2 is an iF award-winning, ultra-portable LED projector that can deliver a convenient, enjoyable entertainment experience anywhere it goes. With a built-in battery, a LED light source with up to 30,000 hours of lifespan, all packaged into less than 1 kg, the M1+_G2 can deliver years of multimedia entertainment wherever it goes – from room to room, both inside and outdoors. Its smart stand enables simple 360-degree setup, while doubling as a lens cover. Once the lens is uncovered, the projector automatically powers on to full brightness for instant entertainment. Stereo Harman Kardon speakers provide room-filling sound for an amplified experience, while more flexible audio needs can be realized via Bluetooth. Integrated Wi-Fi connectivity makes streaming easier than ever – both wireless casting from smart devices and built-in content streaming are possible.

Express Yourself Anywhere You Go

M1+_G2 Portable Cinema



iF Award Design



Metal Stand

Sturdy setup anywhere - no tripod needed.



Lens Cap

The stand also doubles as a lens cover to protect the lens from being damaged when being transported.



Power Combo

Swiveling the stand to uncover the lens powers the projector on in an instant.



Mirror the Screen from Your Phone, to the Projector

Projecting your phone screen to the projector has never been easier. Wirelessly connect the M1+_G2 to your smart device* and enjoy big screen entertainment.



**iPhone and Android phones are supported and they need to be connected under the same network as M1+_G2.*

Streaming Heaven

Say goodbye to cable clutter and external devices. The built-in app center caters to all your entertainment needs. Enjoy your favorite apps from the projector to the big screen or download them – all via Wi-Fi.



**The Apps herein are for demo purpose only and are not preinstalled in the Product. The Apps and their trademarks or logos are the properties of their respective owners, unaffiliated with ViewSonic, and not sponsors or endorsers of the Product.*

Intuitive Touch Control with your phone

Now you can turn your mobile device into an alternative powerful remote control – intuitive touch control, easy typing, and simple annotation on the big screen. Simply download the ViewSonic vCastSender app on your phone, make sure your phone and the projector are connected to the same Wi-Fi network, and pair them up in the app to get started.

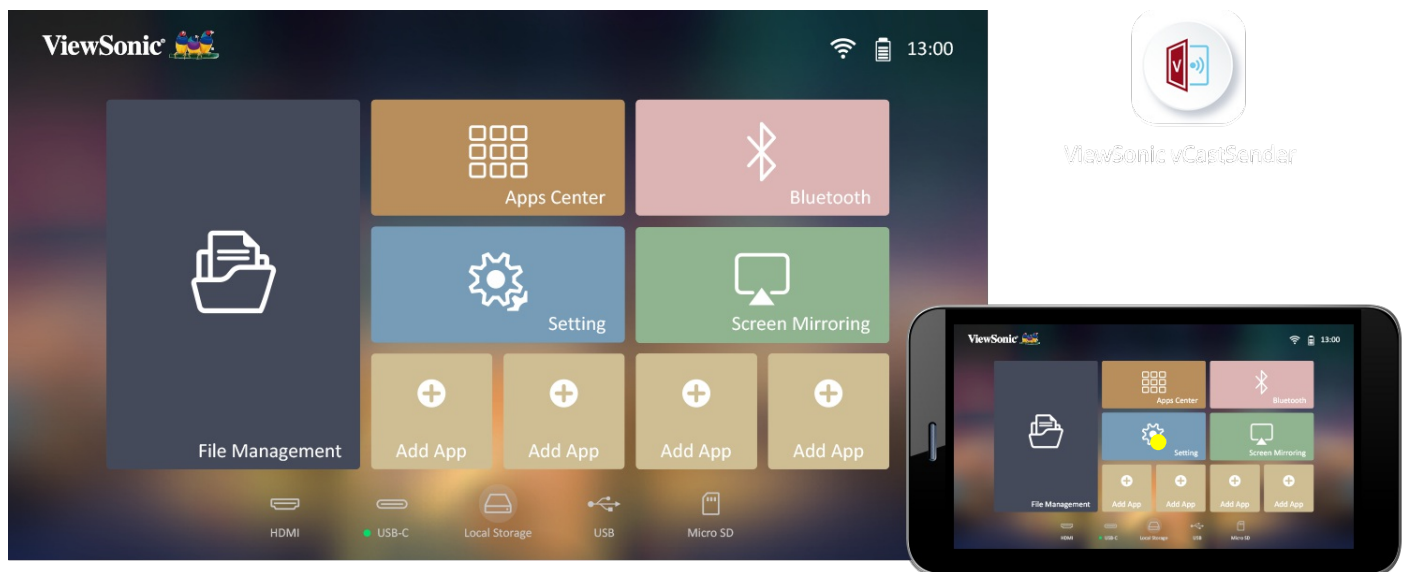

[Learn more](#)



Room-Filling Sound

Dual speakers by Harman Kardon deliver vibrant treble, balanced mids, and strong bass for an all-around immersive experience whether you're watching movies, music videos or listening to a live concert.



Movie Mode

Situate yourself in the movies; home theater made perfect.



Music Mode

Balanced tuning to deliver you the authentic touch of original melodies.



User Mode

With our professional DSP technology, you can customize the way you want to enjoy the audio.

Bluetooth for Flexible Audio Needs

Turn the M1+_G2 into a Bluetooth speaker to play your favorite music in high quality and amplify the pleasure.

Or the other way around, output the audio of a thrilling game from the projector to your own Bluetooth headphones, immersing yourself in your own big screen fun.



Projection in Every Direction

M1+_G2 is the perfect companion for lazy Sundays when you just want to relax and unwind. Whether you're curled up in bed or lounging around on the sofa, watching the latest episode of

your favorite TV show is more comfortable than ever with M1+_G2's 360-degree perfect projection that lets you project images onto the ceiling, wall, floor or anywhere you please - with ease.



Perfectly Proportioned Images Every Time

Say goodbye to distorted images for good. M1+_G2 projects perfectly proportioned images at every angle via the auto keystone feature that corrects images automatically from any angle.

Auto keystone



True-to-life Colors, Fill You with Wonder

True-to-life colors offered by ViewSonic's proprietary Cinema SuperColor+™ Technology with 125% Rec.709 give you the vivid touch and feel for rich emotional pleasure.



Cinematic Experiences On-The-Go

M1+ G2 is a must-have for your next camping trip or outdoor excursion. The built-in battery provides up to 6 hours* of entertainment for you and can be extended easily with a power bank via USB Type-C**, so you don't have to deal with tangled cords or plug the projector into a power source.



** 6 hour battery life is in Battery saving mode*

*** To power on the projector, the power bank should be at least 45W (15V/3A) and support Power Delivery (PD) protocol output.*

Stream Shows on Your Phone, Project Them Anywhere You Go

M1+ G2's USB Type-C connection puts a fun twist on streaming videos and facetimeing your friends by allowing you to project content directly from your phone, laptop or tablet while also charging them simultaneously.

You can even play Switch games on the big screen via direct connection without the dock.



**Only available for devices that support USB Type-C video streaming*

**For iPhone and iPad, users need to buy Apple-authorized Lightning to HDMI adaptor*

Fit for Spaces of All Shapes and Sizes

Project 100'' images from only 2.6 meters away – perfect for usage in small spaces.



Palm Sized

The M1+_G2 is small enough to fit in the palm of your hand and weighs 700g - making it easy to put in your bag or suitcase for presentations on-the-go.



151 × 126 × 40 mm
5.9 × 4.9 × 1.5 inch

Plug & Play

M1+_G2 has a versatile array of connectivity including HDMI and USB Type-C for connecting to your laptop, phone or tablet as well as USB and MicroSD drives. 12GB of local storage allows you to save your favorite content directly onto the projector itself.



Smart UI for Intuitive Navigation

Free yourself from struggling finding the things you want. With our intuitive and user-friendly interface design, you can relaxingly navigate around, select a command, or add favorite applications to the menu.

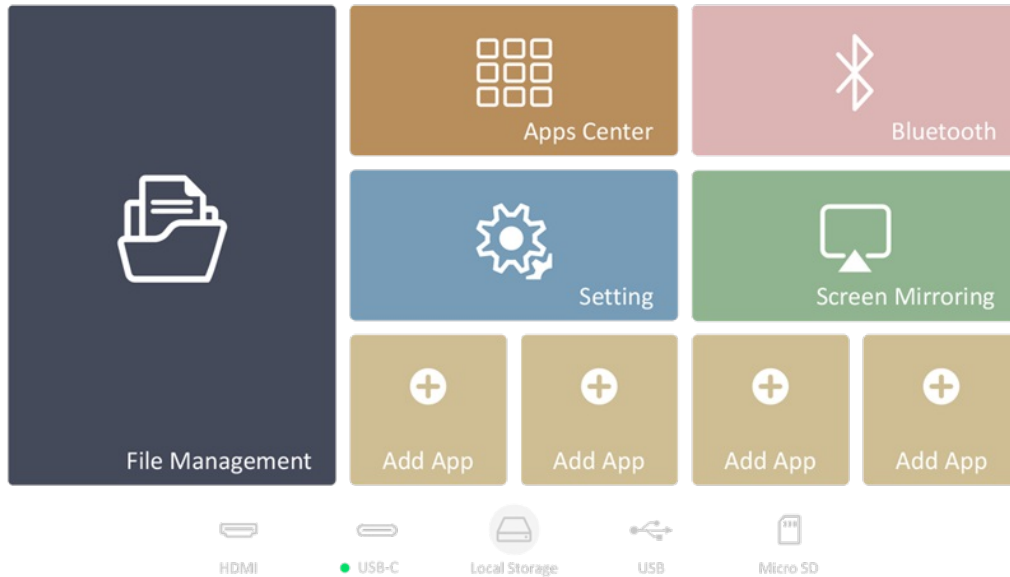

Up to 30,000 Hours Light Source Life

LED technology offers up to 30,000 hours of usage – a significant upgrade when compared to traditional mercury lamp projectors.

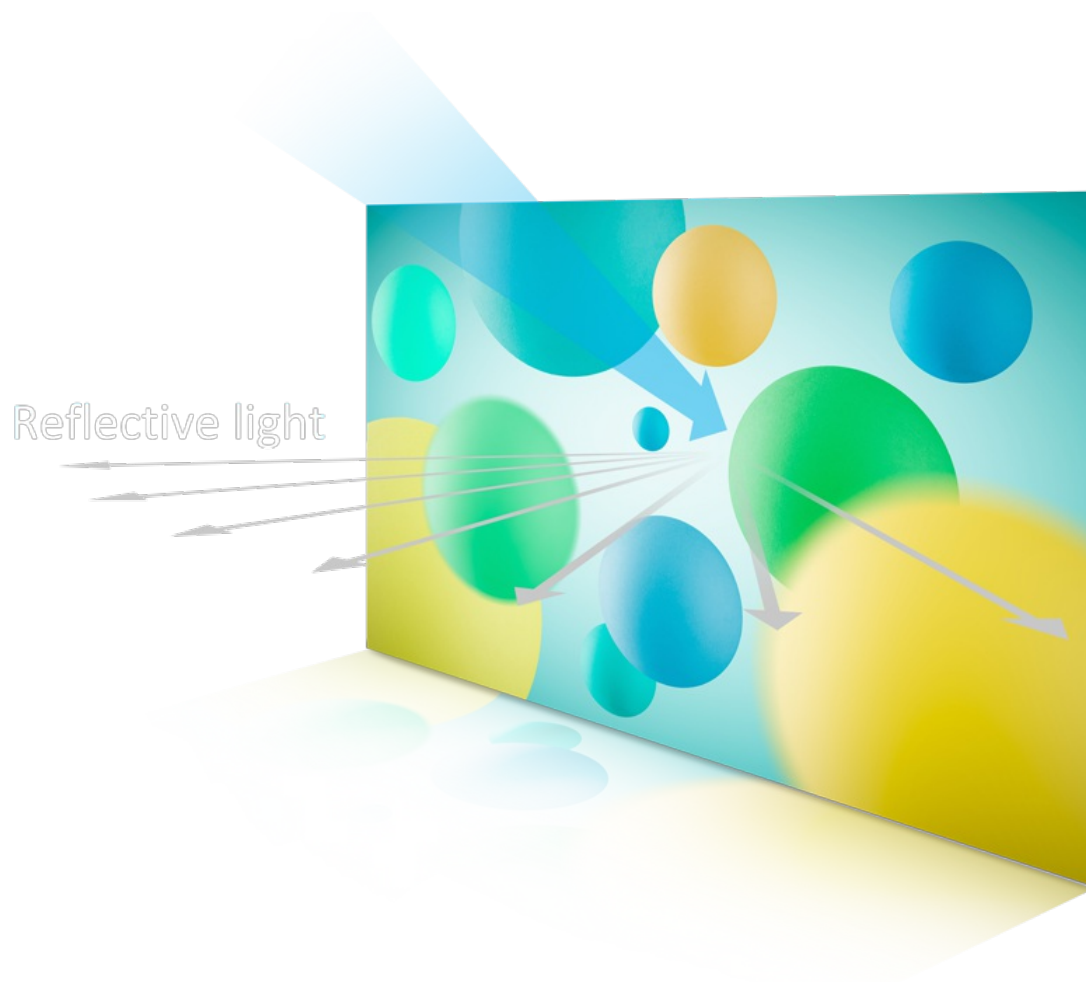

Eye Care

Utilizing reflective light, which bounces off the wall or projector screen before hitting your eyes, the projector makes the viewing experience virtually blue light free, less invasive to your sight and reduces eyestrain over prolonged viewing periods.



TÜV-Certified Antibacterial Remote Control

Stay entertained, stay healthy.
Our antibacterial remote control adopts a special coating with silver ions, which prevents bacteria from attaching and remains effective even after a long period of use.

Green Design

Packaging for the M1+_G2 portable projector is paper-based, biodegradable, and 99% recyclable – all the right ingredients for leaving a smaller carbon footprint.



Exterior & Rear I/O Connectors

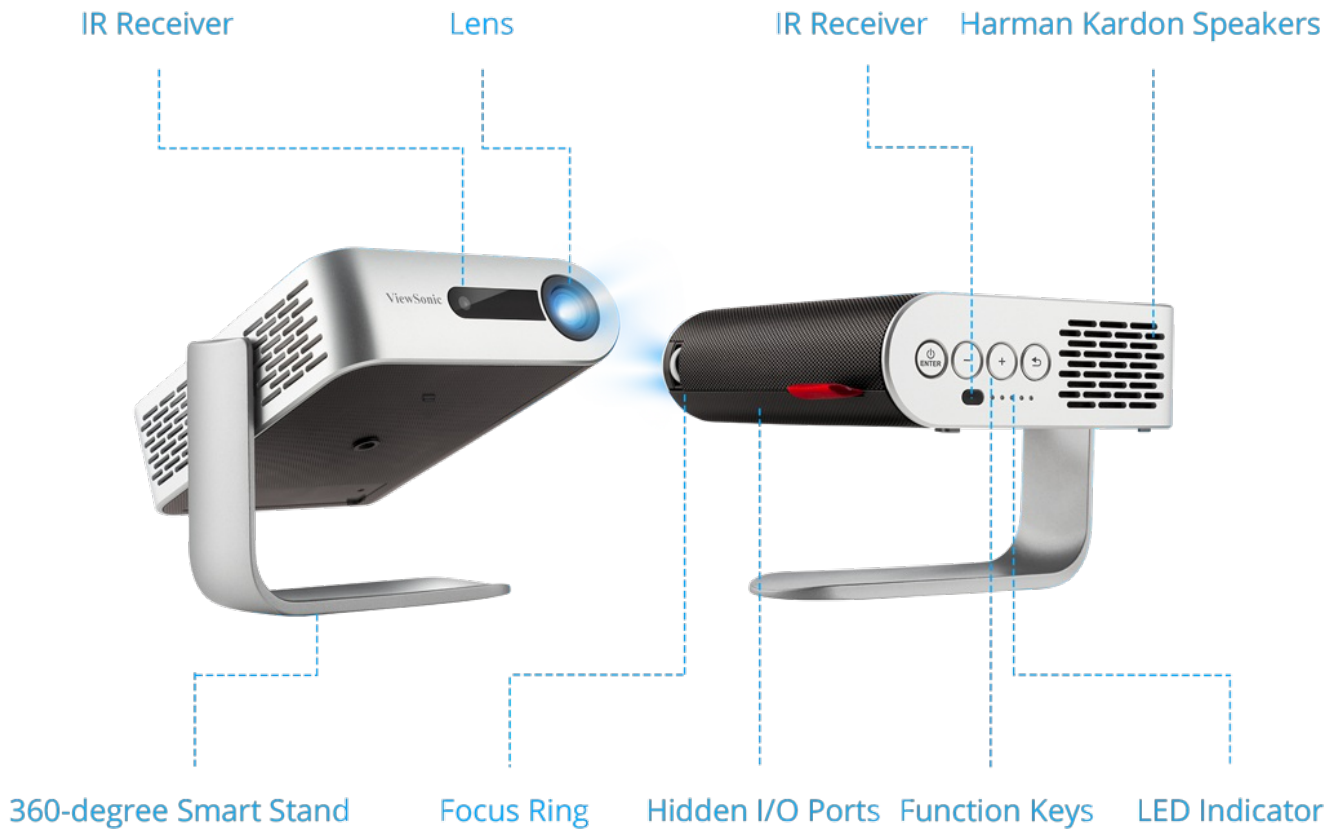

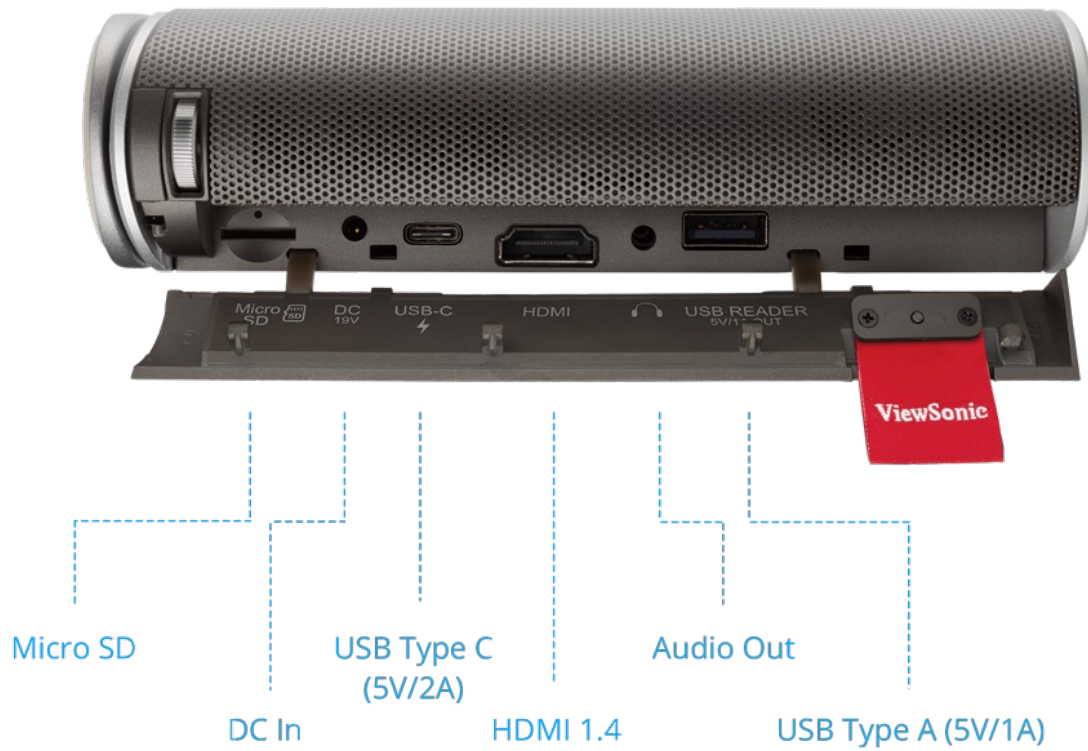

Technical Specifications

Specification	Projection System	0.2" WVGA
	Native Resolution	854x480
	Brightness	300 (LED Lumens)
	Contrast Ratio	120000:1
	Display Color	1.07 Billion Colors
	Light Source Type	LED
	Light Source Life (hours) with Normal Mode	up to 30000
	Lamp Watt	RGB LED
	Lens	F=1.7, f=5.5mm
	Projection Offset	100%+/-5%
	Throw Ratio	1.2
	Optical Zoom	Fixed
	Image Size	24"-100"
	Throw Distance	0.64m-2.66m, (38"@1m)
	Keystone	+/- 40° (V)
	Audible Noise (Normal)	26dB
	Audible Noise (Eco)	25dB
	Local Storage	Total 16GB , (12GB available storage)
	Input Lag	41.5ms
	Resolution Support	VGA(640 x 480) to FullHD(1920 x 1080)
	HDTV Compatibility	480i, 480p, 576i, 576p, 720p, 1080i, 1080p
	Horizontal Frequency	15K-102KHz
	Vertical Scan Rate	23-120Hz

Input	HDMI	1, (HDMI 1.4/ HDCP 1.4)
	USB Type C	1 (5V/ 2A)
	Audio-in (Bluetooth)	1 (BT4.2)
	USB Type A	1, (USB2.0 Reader)
	SD Card	Micro SD (32GB, SDHC)
	Wifi Input	1 (5Gn)
Output	Audio out (3.5mm)	1
	Audio-out (Bluetooth)	1 (BT4.2)
	Speaker	3W Cube x2
	USB Type A (Power)	1 , (USB2.0 - 5V/1A,, share with USB A Input)
Others	Power Supply Voltage	Power adaptor: , Input: 100~240V, Output: 19VDC / 3.42A, , Battery:, 12000mAh(4000mAh 3.7Vx3), (2.5hrs@Normal, 3hrs@Eco)
	Power Consumption	Normal: 45W , Standby: <0.5W
	Operating Temperature	0~40°C
	Net Weight	0.7kg
	Dimensions (WxDxH) with Adjustment Foot	151x126x40mm
	OSD Language	English, French, Spanish, Thai, Korean, German, Italian, Russian, Swedish, Dutch, Polish, Czech, T-Chinese, S-Chinese, Japanese, Turkish, Portuguese, Finnish, Indonesian, India, Arabic, Vietnamese, Greek, Total 23 languages
Standard Accessory	Power Cord	1
	USB-C Cable	1 (1m)
	Remote Control	1
	QSG	Yes
Optional Accessory	Carry Bag	PJ-CASE-010