



XPC slim DH610

12th GEN HYBRID POWER MAKES MULTITASK EASY

Shuttle XPC Slim series DH610 supports Intel® 12th Gen LGA1700 processors. With Intel® hybrid architecture and UHD graphics 700 series integrated, the model computes performance along with the potential for powering AI deployment. DH610 provides comprehensive connectivity with multiple ports, including four USB 3.2 Gen1 (Include one Type-C), four USB 2.0, two RS232, Intel® 2.5GbE + Intel® 1GbE LAN, and two M.2 expansion slots. Support up to three displays via one HDMI 2.0 and two DisplayPort. In sum, DH610 can perform a reliable operation for Office, Digital Signage, Kiosks, and other Multi-platform AI deployment.



TRIPLE DISPLAY

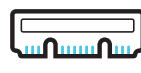

M.2



2.5G LAN



VESA MOUNT



ENVIRONMENT

FEATURES

- Support Intel® 12th Core™ i3/i5/i7/i9, Pentium® Gold, Celeron® 65W processor
- Support up to 64GB DDR4-3200 memory
- Support three independent displays via one HDMI 2.0b and two DisplayPort
- Flexible connectivity: one M.2 2280 M Key (PCIe 3.0 x 4/SATA), one M.2 2230 E Key, four USB 3.2 Gen1 (Include one Type-C), four USB 2.0, and two RS232
- Intel® 2.5GbE + Intel® 1GbE LAN that supports Wake On Lan and Teaming Mode

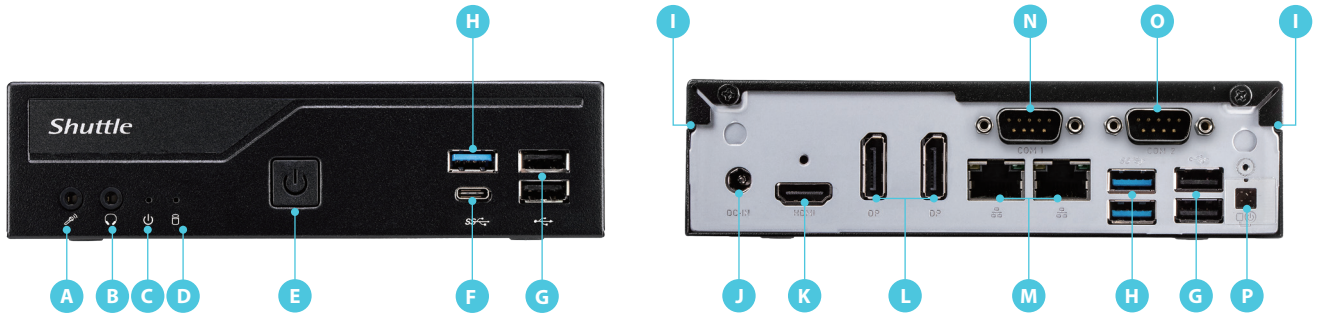

- A** MIC-IN
- B** Headphones
- C** Power LED
- D** Hard Disk Drive LED
- E** Power Button
- F** USB 3.2 Gen 1 (Type-C)
- G** USB 2.0 Ports
- H** USB 3.2 Gen 1 (Type-A)
- I** Kensington® Lock Hole
- J** Power Jack (DC IN)
- K** HDMI 2.0
- L** DisplayPort
- M** LAN Ports
- N** COM 1 Port (RS232/RS422/RS485)
- O** COM 2 Port (RS232 only)
- P** Clear CMOS & Power Button & +5V

SPECIFICATIONS

| | | DH610 |
|----------------------------|---------------------------|---|
| Model | | DH610 |
| Cooling system | | Smart fan |
| CPU | | Intel® 12 th Gen LGA1700 socket Core i3/i5/i7/i9, Pentium, Celeron 65W processor |
| Chipset | | Intel® H610 |
| Video Engine Processor | | Intel® UHD Graphics series |
| Max Resolution | | HDMI 4096 x 2160@60Hz DisplayPort 4096 x 2160@60Hz |
| Memory | | 2 x DDR4 3200/2933/2666 MHz, Max. 64GB |
| Storage | | 1 x 2.5" HDD/SSD (max. 12.5 mm) |
| Expansion Slot | | 1 x M.2 2280, M Key 1 x M.2 2230, E Key |
| Video Output | HDMI Port | 1 |
| | DisplayPort | 2 |
| | VGA Port | Optional |
| I/O Port | USB 3.2 Gen1/Gen2 (Front) | 2(Include Type C x 1) / - |
| | USB 2.0 (Front) | 2 |
| | USB 3.2 Gen1/Gen2 (Rear) | 2 / - |
| | USB 2.0 (Rear) | 2 |
| | COM Port | 1 x RS232 1 x RS232/422/485, Support 5V/12V |
| Network | LAN | 1 / 1 |
| | Wifi | 1 x Intel® 1G LAN 1 x Intel® 2.5G LAN |
| VESA | | Optional |
| Dimension (L/W/H) mm | | Bracket included 190 x 165 x 43 |
| Weight | NW (kg) | 1.3 |
| | GW (kg) | 2.05 |
| Certification | | CB, CE, BSMI, cTUVus, FCC, RCM, RoHS, VCCI |
| Operating Temperature (°C) | | 0~50 |
| Chassis | | Metal |
| Power Supply | | 19V/6.32A 120W external adapter |
| Operating System | | Windows 10/11 64bit, Linux |
| Optional Accessories | | WLN-M, PVG01, PS02, WWN03 |